

Sheaves

8V SERIES 6 GROOVE/QD

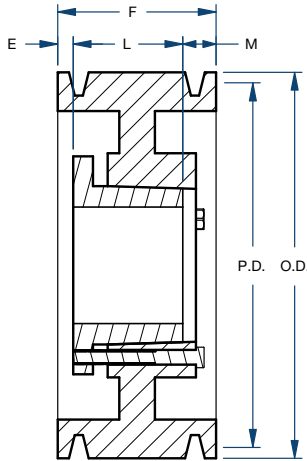

BLACKSTAR®



Type A

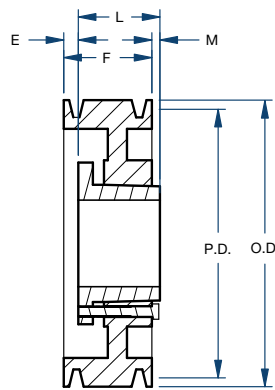

Type B

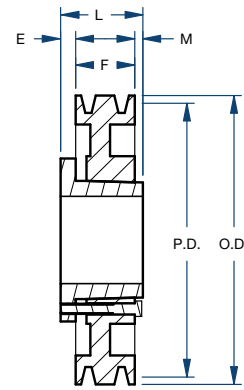

Type C

Part Number	Bushing	Bore Range	Type	Diameter (in)		Dimensions (in)				Weight less Bushing (lbs)
				Pitch	Outside	E	F	L	M	
6-8V1250F	F	1 – 4	A	12.30	12.50	31/32	7-1/8	3-3/4	2-13/32	90.0
6-8V1320F	F	1 – 4	A	13.00	13.20	31/32	7-1/8	3-3/4	2-13/32	98.0
6-8V1400F	F	1 – 4	A	13.80	14.00	31/32	7-1/8	3-3/4	2-13/32	112.0
6-8V1500J	J	1-1/2 – 4-1/2	A	14.80	15.00	1-1/8	7-1/8	4-5/8	1-3/8	123.0
6-8V1600J	J	1-1/2 – 4-1/2	A	15.80	16.00	1-1/8	7-1/8	4-5/8	1-3/8	129.0
6-8V1700J	J	1-1/2 – 4-1/2	A	16.80	17.00	1-1/8	7-1/8	4-5/8	1-3/8	136.0
6-8V1800J	J	1-1/2 – 4-1/2	A	17.80	18.00	1-1/8	7-1/8	4-5/8	1-3/8	143.0
6-8V1900J	J	1-1/2 – 4-1/2	A	18.80	19.00	1-1/8	7-1/8	4-5/8	1-3/8	157.0
6-8V2000M	M	2 – 5-1/2	B	19.80	20.00	1-11/32	7-1/8	6-3/4	31/32	179.0
6-8V2120M	M	2 – 5-1/2	B	21.00	21.20	1-11/32	7-1/8	6-3/4	31/32	193.0
6-8V2240M	M	2 – 5-1/2	B	22.20	22.40	1-11/32	7-1/8	6-3/4	31/32	205.0
6-8V2480M	M	2 – 5-1/2	A	24.60	24.80	11/32	7-1/8	6-3/4	1/32	235.0
6-8V3000M	M	2 – 5-1/2	A	29.80	30.00	11/32	7-1/8	6-3/4	1/32	285.0
6-8V3550N	N	2-7/16 – 5-7/8	C	35.30	35.50	15/16	7-1/8	8-1/8	1/16	340.0
6-8V4000N	N	2-7/16 – 5-7/8	C	39.80	40.00	15/16	7-1/8	8-1/8	1/16	394.0
6-8V4450N	N	2-7/16 – 5-7/8	C	44.30	44.50	15/16	7-1/8	8-1/8	1/16	489.0
6-8V5300N	N	2-7/16 – 5-7/8	C	52.80	53.00	15/16	7-1/8	8-1/8	1/16	584.0